

TECHNICAL SPECIFICATIONS

# SNAPPER

---

D I S P L A Y

**JOHANNESBURG:**

TEL: (011) 708 - 1538      FAX: (011) 708 - 1533  
sales@snapperdisplay.co.za

**CAPE TOWN:**

TEL: (021) 534 - 5050      FAX: (021) 534 - 5051  
snapdis@mweb.co.za

[www.snapperdisplay.co.za](http://www.snapperdisplay.co.za)

## Destiny

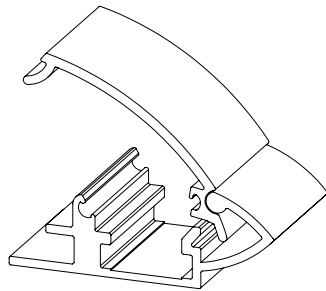
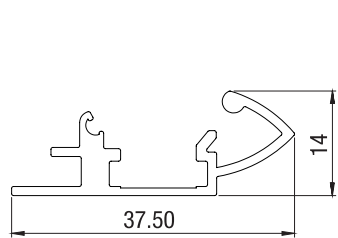
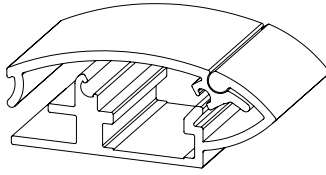
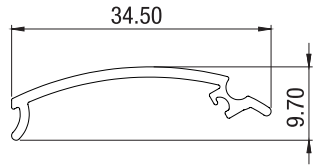

## Slide Frames

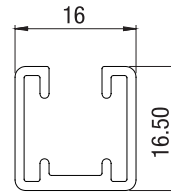
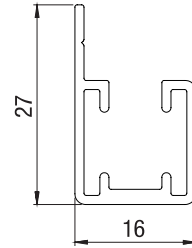

### Square Single Sided

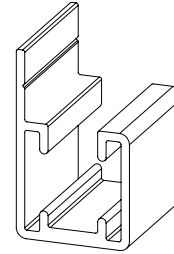

### Square Double Sided

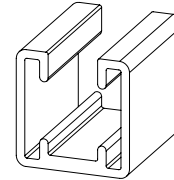

## Suspend-It

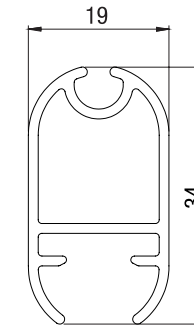
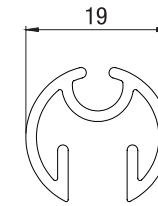

## Classic

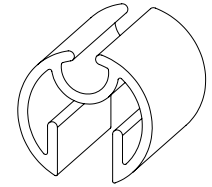

## Jumbo

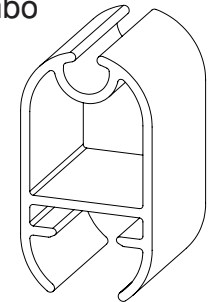

### The following profiles can be manufactured as LED units:

- Classic
- Narrow
- Midi
- Jumbo
- 44mm Uni-Frame
- 32mm Uni-Frame

### The Standard Colours we offer:

### Anodised colours with estimated colour reference:

Eskom Bronze



Bright Silver



Natural Anodised  
(Matt Silver)



Matt Brass



Bright Brass  
(Gold)



Other colours available on request.

Anodised colours are subject to variation by batch.

### Powder coated colours with estimated Pantone references:

Gloss White



Ultramarine Blue  
Pantone - Reflex Blue



Medium Yellow  
Pantone - 1235



Cobalt Blue  
Pantone - 282



Satin Black



Traffic Red  
Pantone 1795



Moss Green  
Pantone - 560



Other colours available on request.

**Classic - Double Sided**

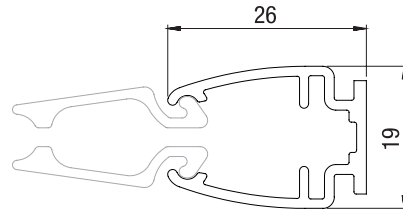
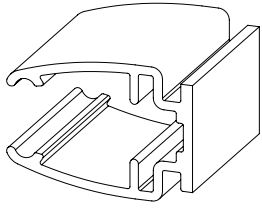

**Classic Snap**

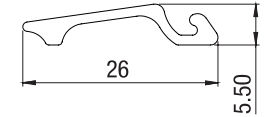
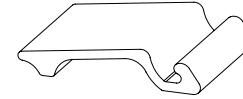

**Narrow**

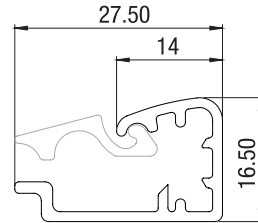
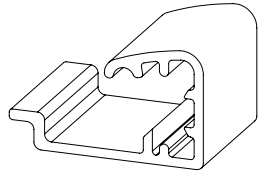

**Narrow Snap**

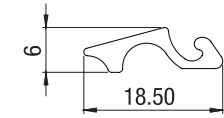

**Classic**

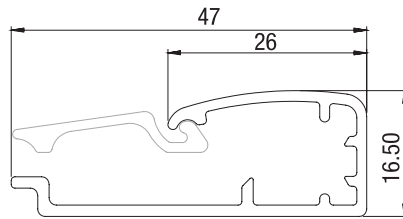
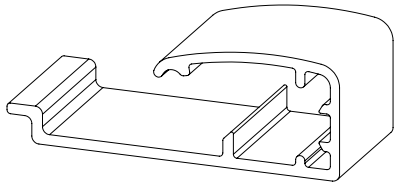

**Tamper Resist Snap**

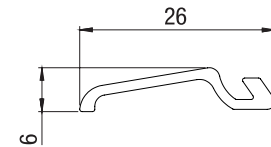
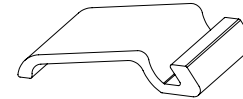

**Midi**

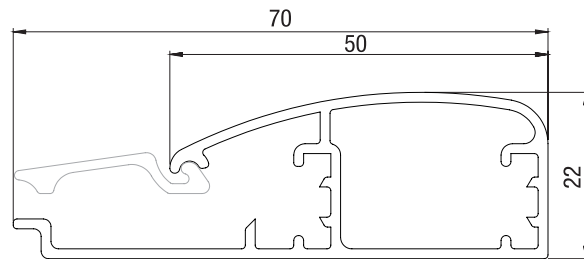
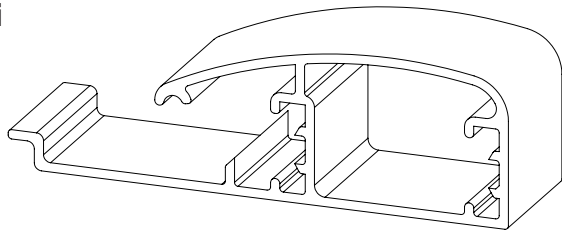

**Jumbo Snap**

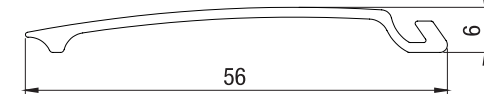
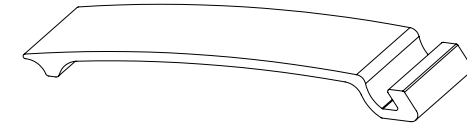

**Jumbo**

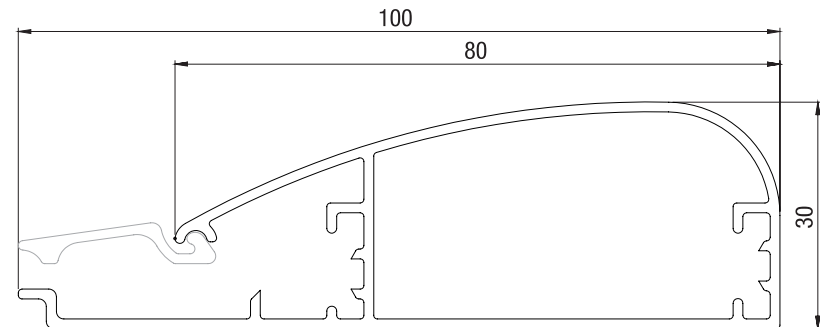
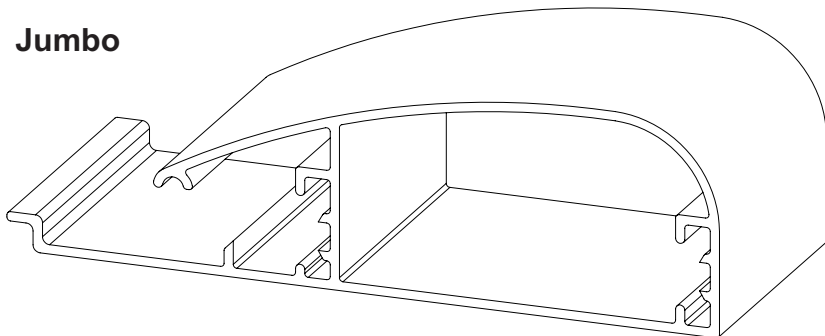

### 25mm Snap

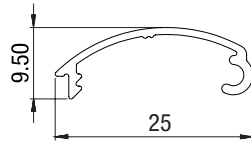
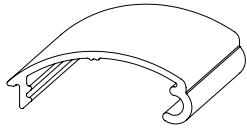

### 25mm backing

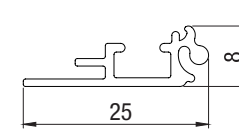
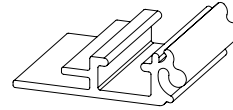

This profile is particularly suited to small frame typically upto A2.

### 32mm Uni - Frame

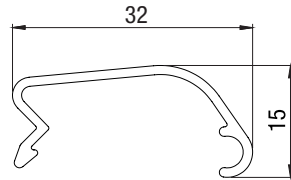
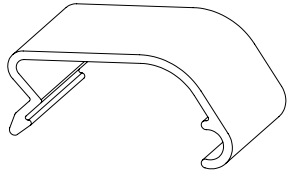

### 32mm body for 3 - 3.5mm backing

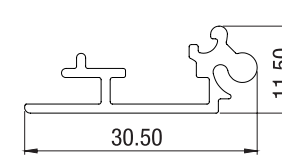
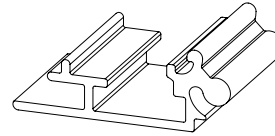

32mm profiles are suited to general purpose usage for a wide range of sizes. Available with rounded corners.

### 32mm Tamper Resist Uni - Frame

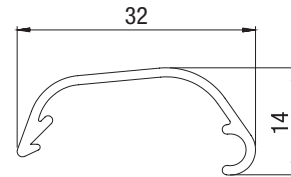
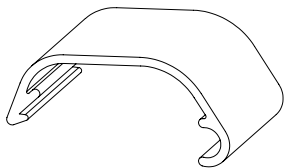

### 32mm Thin body for 0.5 - 1.2mm backing

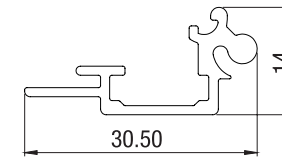
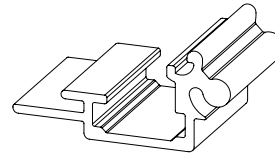

Tamper-resist profile to be used where tampering with the posters is to be discouraged. Bullnose finish makes opening of frame more difficult.

### 44mm Uni - Frame

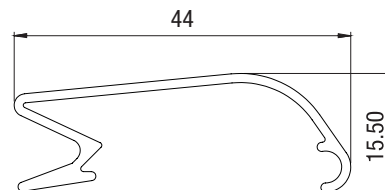
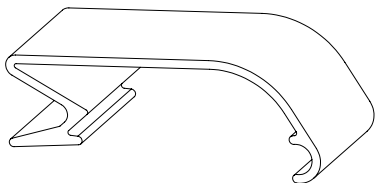

### 32mm Hollowback (removable backing)

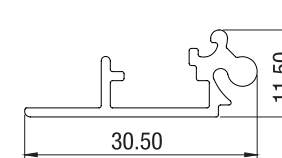
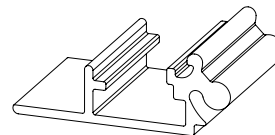

44mm frame best suited to large applications requiring large frames, typically A1 or bigger.